

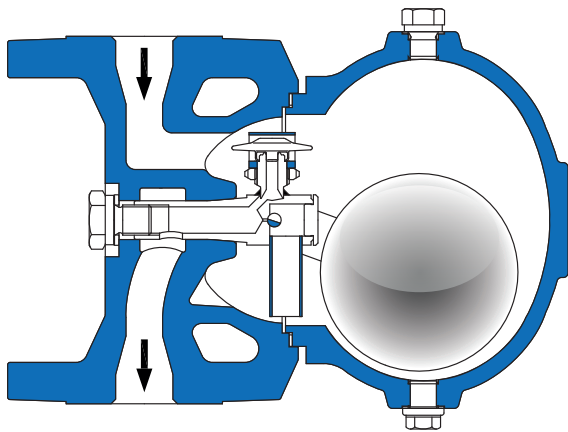

RIFOmat Float-Controlled Trap - Model Vario S

1000

PN 16



Housing-Material: EN-JS 1049

Nominal diameter: DN15, DN20, DN25

Connections:

- Flanges DN 15-25, acc. DIN EN 1092-2, PN16
- Flanges 1/2"-1", acc. ANSI B 16.5, Class 150
- Female thread G 1/2"-1" (BSP) acc. DIN ISO 228-1
- Female thread 1/2"-3/4" NPT acc. ANSI B 1.20.1
- Other connections on request

Nominal pressure stage: PN 16

Operation limits:

Max. working pressure (bar g)	16	14,7	12,8	11,2
Max. working temperature (°C)	-10/120	200	300	350

Working media: Steam and steam condensate

Function: Increasing level opens and decreasing level closes the outlet without delay, independent of pressure and temperature fluctuations. The rotary slide valve is both, swivel joint and shut-off device.

Special characteristics: A float-controlled trap for all flow directions and face to face length to DIN 3548, short series. The RIFOmat Vario S will be assembled as specified by customer. A change of flow direction can be accomplished in situ by merely rotating the housing flange part and repositing the float control unit. The RIFOkA-Venting to interior on the control unit is standard.

Functionlimit of the control unit: 15 bar g

Installation: horizontal oder vertical

Optional:

- Housing gasket made of Novapress



Performance:

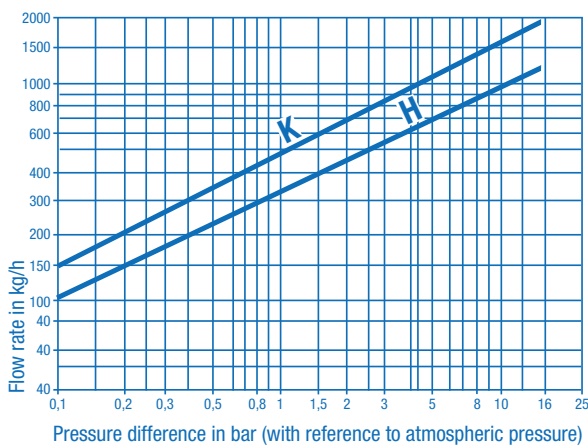

The diagram shows the capacity of hot condensate (H) and cold condensate (K) up to 60°C.

RIFOkA Venting interior

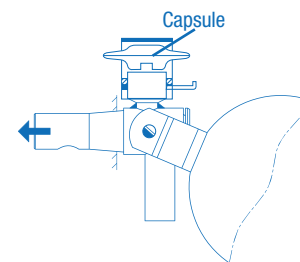

For start-up and permanent venting with high venting capacity. A special liquid inside the membran capsule evaporates and condenses only a few degrees below the boiling point or water.

CE - Mark:

The pressure equipment described is a pressure-keeping component in accordance with the Pressure Vessel Directive 97/23/EC and since capacity is less than 1 litre, it bears no CE-mark, in accordance with Article 3, subsection 3.

Please state the following when making inquiries / placing orders: Unit type, flow direction Medium, density, initial pressure, counter pressure, temperature, quantity of condensation (kg/h).



Installation Dimensions

1000

PN 16

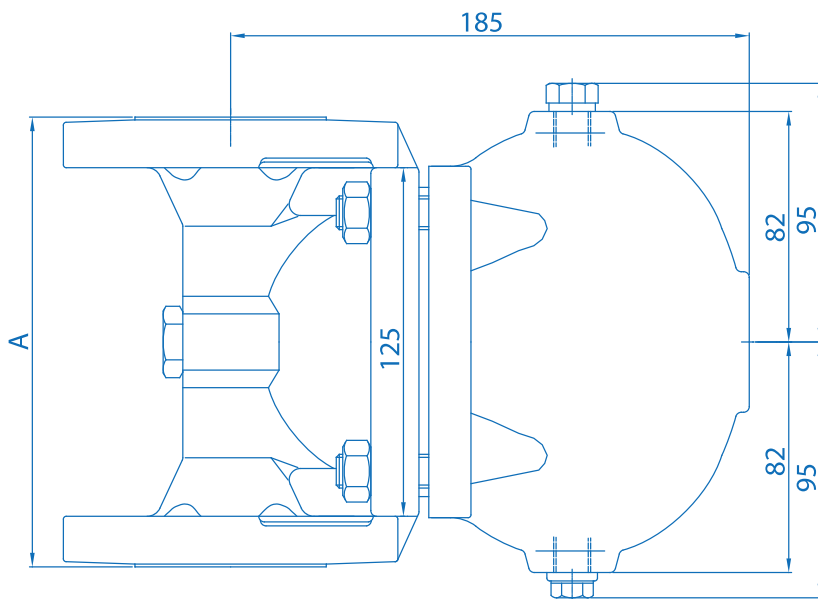

Dimensions (in mm), Weight (in kg)

DN	15 (1/2")	20 (3/4")	25 (1")
A	150	150	160
kg	8	8	9

Spare Parts

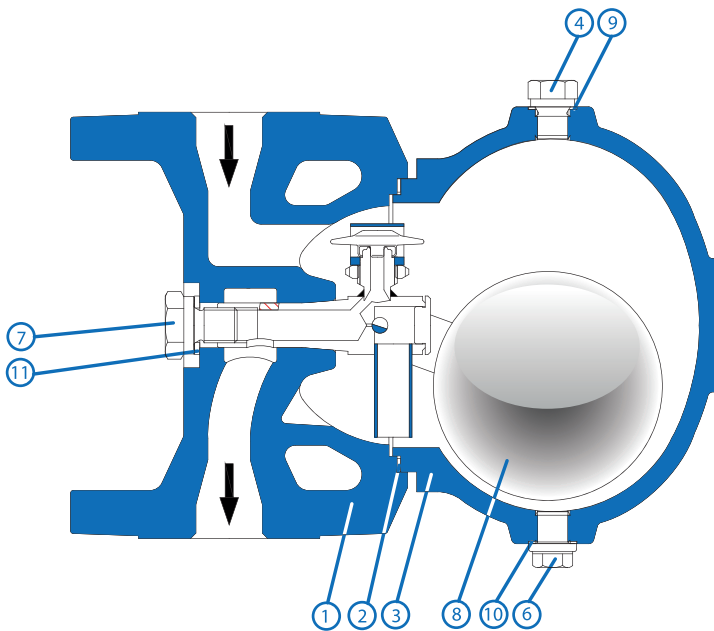

1 **Housing flange part:** EN-JS 1049

2 **Housing gasket:** Novaphite

3 **Housing side part:** EN-JS 1049

4 **Control screw:** 1.4104

5 **Set of stud bolts and nuts:**
DIN 939 / ISO 4032 (not visible)

6 **Drain plug:** DIN 910 - 5.8 - G 1/4" (BSP)

7 **Support screw:** 1.4104

8 **Float control unit*:** 1.4057/1.4112/1.4301

9 **Control screw gasket:** Soft iron

10 **Drain plug gasket:** Soft iron

11 **Support screw gasket:** 1.4571

* Due to sealing requirements marked items cannot be supplied as individual parts.

To ensure correct parts delivery, specify part number, works standard sheet number 1000 on the DN.