

Housing material: 10CrMo9-10

Nominal diameter: DN15, DN20, DN25

Connections:

- Flanges DN 15-25, acc. DIN EN 1092-1, PN160
- Flanges 1/2"-1", acc. ANSI B 16.5, Class 1500
- Female thread G 1/2"-1" (BSP) acc. DIN ISO 228-1
- Female thread 1/2"-1" NPT acc. ANSI B 1.20.1
- Butt weld DN 15-25 acc. DIN EN 12627 and ANSI B 16.25
- Socket weld DN 15-25 acc. DN EN 12760 and ANSI B 16.11
- Other connections on request

Nominal pressure stage: PN 160

Housing operation-limits:

Max. operating pressure in bar g	160	146	139	118	79	52
Max. operating temperature in °C	up to 300	400	450	500	520	550

Media: Steam, condensate

Function: A temperature drop opens while an increase of temperature closes the passage. As steam temperature the valve closes.

Installation: Horizontal or vertical

Function-limit of inlet unit: max. pressure difference = 140 bar

CE Mark

The pressure equipment is in accordance with the Pressure Vessel Directive 97/23/EC, Article 3, subsection 3 and bears no CE mark.

Please state the following when making inquiries/placing orders:

High or low cooling range of condensate, actual operating pressure and quantity of condensate (kg/h).

Performance

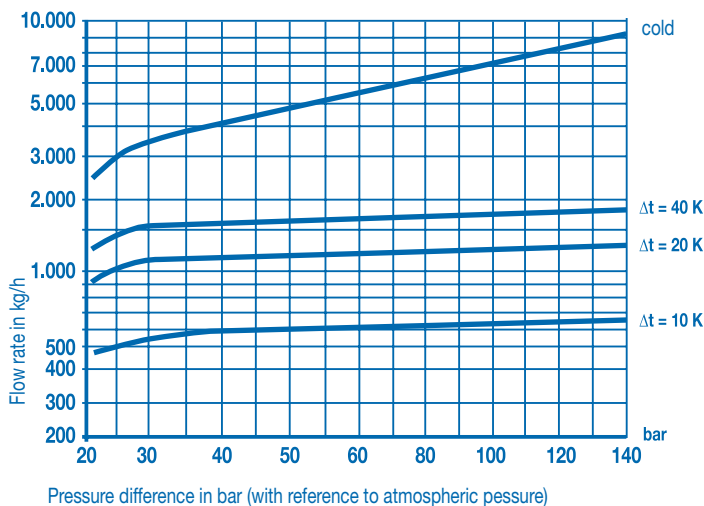

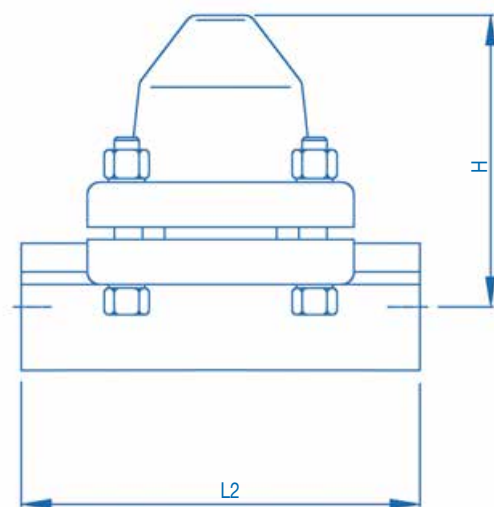
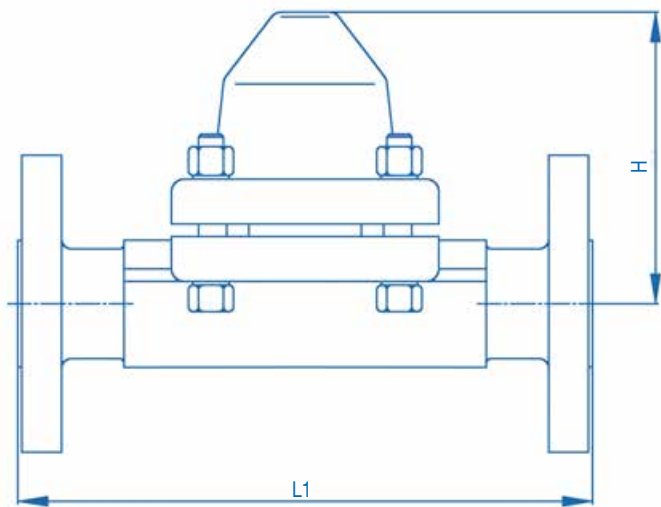

DN	15 (1/2")	20 (3/4")	25 (1")
L1	230	230	230
L2	160	160	160
H	120	120	120
Weight with flanges	8,3	9,1	9,5
Weight without flanges	6,8	6,8	6,8

Dimensions (in mm), weight (in kg)

Spare Parts

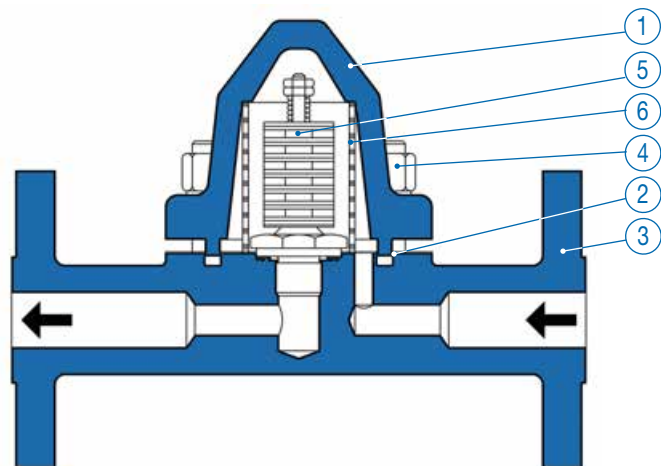

- 1 **Upper housing:** 10CrMo9-10 comparable with ASTM A 182 F22
- 2 **Housing gasket:** Graphite
- 3 **Lower housing:** 10CrMo9-10 comparable with ASTM A 182 F22
- 4 **Set screws with nuts:** 42CrMo4 / 24CrMo5 comparable with ASTM A 193 Gr. B7 / ASTM A 194
- 5 **Bi-metal control assembly:** Stainless steel, Bi-Metall
- 6 **Strainer:** 1.4301 comparable with AISI 304

To ensure correct parts delivery, specify part number, works standard sheet number 2550 and DN.